

1. Attach rear wheel (11) to beam (10) with washer (12), and pin (13).
2. Attach caster (18) to front leg (17) with washer(6), spring washer(7) and nut (8).
3. Attach cross member(15) to the front leg(17) with bolt (16), washer (6), spring washer(7) and nut (8).
4. Attach cross member(15) to the mast assembly(9) connecting beam (10) with bolt (14) and spring washer(7).
5. Attach head assembly (2) to mounting arms (5) with bolt (4), washer (6), spring washer(7) and nut (8).
6. Insert head assembly (2) into the hole of the mast assembly(9). Line up the hole in the head assembly (2) and the mast assembly(9), and assembly them by inserting the lock pin(1).
7. Tight all the screws.

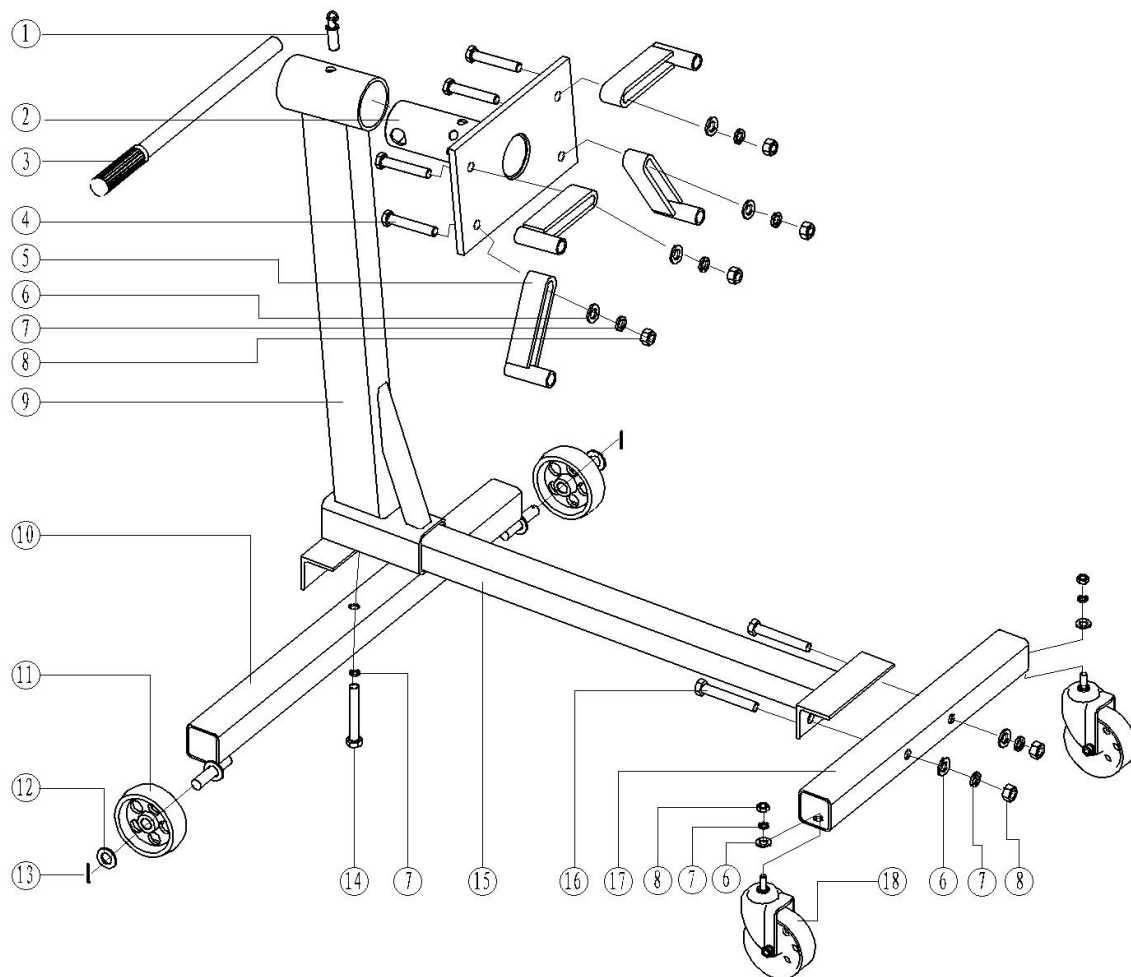

Item	Name	Part No.	Qty.
01	Lock Pin	T23401-1	1
02	Head Assembly	T23401D.3	1
03	Handle	T23401D-2	1
04	Bolt M12x65	GB5780	4
05	Mounting Arms	T23401D.1	4
06	Washer 12	GB95	8
07	Spring Washer 12	GB93	9
08	Nut M12	GB41	8
09	Mast Assembly	T23401D.2	1
10	Beam	T23401D.4	1
11	Wheel	T23401D-1	2
12	Washer 14	GB95	2
13	Pin 2x22	GB91	2
14	Bolt M12x80	GB5780	1
15	Cross Member	T24541D.2	1
16	Bolt M12x70	GB5780	2
17	Front Leg	T24541D.1	1
18	3"Caster		2