

WIDTH SPRAY GUN

Please read and understand these instructions carefully for use.

Operating instructions

W-871



Type and purpose

Type	Nozzle aperture	Applicable coating	Coating supply type	Purpose
W-871-1	2.5 Ø	Varnish, adhesive, outer protective coating, sand wall coating (colored)	Forced supply type (fill type)	Apply a little
			Forced supply type (tank type)	Apply a lot
W-871-2	3.0 Ø	Sand wall coating (colored), varnish, adhesive, clastic tile overglaze, filling	Forced supply type (tank type)	Apply a lot
			Forced supply type (pump type)	

Please read wall coating column on the back carefully.

Coating is delivered by means of forced supply within the spray gun.

PARTS LIST

No.	Description	Pcs
1	Cover	1
2	Air Cap (25W)	1
3	Fluid Nozzle	1
4	Packing-Fluid Needle Set	1
5	Gun Body	1
6	Air Adj. Valve Set	1
7	O Ring	1
8	Fluid Adj. Guide	1
9	Fluid Needle Set	1
10	Fluid Needle Spring	1
11	Lock Nut	1
12	Fluid Adj. Knob	1
13	Air Valve Seat Set	1
14	Air Valve	1
15	Air Valve Spring	1
16	Air Valve Spring Seat	2
17	Air Hose Joint	1
18	Trigger Stud	1
19	Trigger	1
20	Stop Ring	1
21	Fluid Joint	1
22	Gasket	1
23	Air Cap (10W)	1
24	Joint	1
25	Nut	1
26	Spanner	1
27	Brush	1

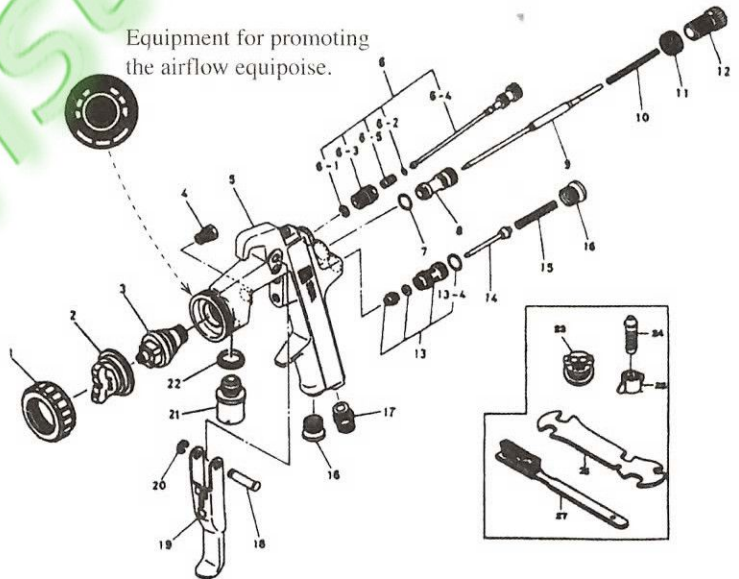

Equipment for promoting the airflow equipoise.

When checking components, please disassemble them in turn and remember their positions.

1. Introduction

- (1). Selection of supply mode: supply method of direct connection with pressure pot or spray pressure barrel may be selected according to coating quantity, of which type I may be supplied by means of direct connection with 1000 ml pressure pot or Model PT - 10 pressure barrel. Type II may be supplied by Model PT-10 pressure barrel.
- (2). Selection of operating air pressure: subject to coating viscosity, property and customer's requirement, see the figure on the right for coating indexes. When pressure barrel is used for supply, supply pressure should be kept at about 1 kgf/cm², also refer to operating instructions of spray pressure barrel.
- (3). Selection of air cover: two air covers may be selected according to coating viscosity, property and air pressure, i.e. 25W and 10W, refer to the figure on the right for selection.

Coating	Colorful coating	F coating, adhesive, outer coating
Operating air pressure	2 - 3 kgf/ cm ²	3 - 4 kgf/ cm ²

Type of air cover	25W	10W
Spray length	25 - 40 cm	10 - 25 cm

2. Usage

(1). Spray distance

Difference may exist somehow due to difference of air pressure and coating viscosity, generally 20 - 30 cm to working surface.

(2). Adjustment of spray direction

Your desired spray direction may be achieved by turning air cover, as shown in the figure below.

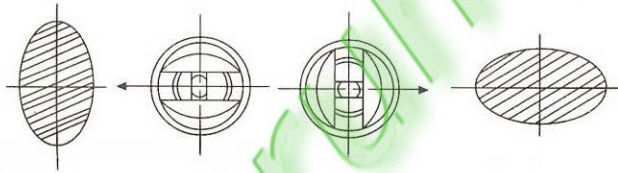

(3). Usage of adjuster

①. Adjustment of air intake:

Air intake may be adjusted by turning air quantity adjusting knob ⑥. Sprayed particle size may be controlled by adjusting spray quantity of coating.

②. Coating spray adjuster

Turn coating adjusting knob ⑫ rightwards to the maximum, lock the needle, now only air is sprayed, then inversely turn leftwards, coating will become more and more, generally 6 turns lead to the maximum.

③. Use two-position interval of trigger

There are two positions in the process of triggering, when the trigger is released for the first time, only air will be sprayed out, it may be used to remove dust and foreign bodies etc on working surface; when the trigger is released for the second time, coating will be sprayed out.

3. Precautions

- (1). When direct connection with pressure pot is selected for supply, in order to achieve good spray effect, always fasten connecting parts, and pressure should not exceed 5 kgf/cm², otherwise accident might occur.
- (2). To disassemble and install parts, always wipe off dust and foreign bodies.
- (3). Never damage air cover opening and nozzle orifice, otherwise mist spray might occur.
- (4). Never dip the complete spray gun into thinner etc chemical agents.
- (5). Never spray to people or animals.

4. Maintenance after use

In order to extend service life of spray gun and facilitate work later, always clean the gun in time

- (1). In order to clean coating channel, pour water or detergent into the container, operate in the same way as spraying until clean water or detergent is sprayed out.
- (2). Air cover opening and nozzle etc should be cleaned with brushes, especially air channel etc should be cleaned out with brush finish rocking inside.
- (3). After cleaning, joint moving parts should be applied with appropriate amount of lubricating oil.